

POSITIVE

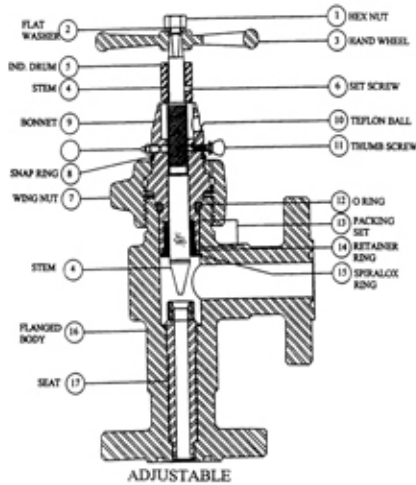

ADJUSTABLE

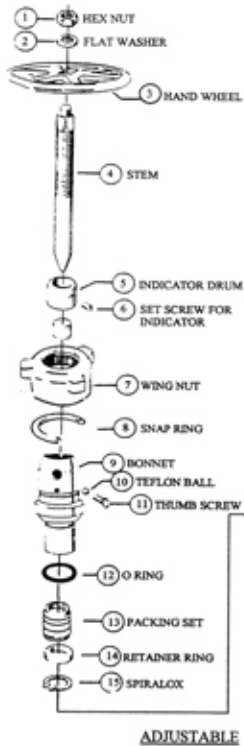

ADJUSTABLE

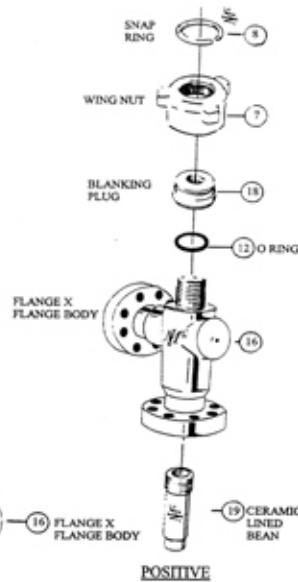

POSITIVE

ADJUSTABLE AND POSITIVE CHOKE ASSEMBLIES

PART NO.	DESCRIPTION
M10AFFR72	2-1/16" 10,000 LB FXF ADJ CHOKE HS 3/4"
M10AFFC72	2-1/16" 10,000 LB FXF ADJ CHOKE CARB. 3/4"
M10AFFC72S	2-1/16" 10,000 LB FXF ADJ CHOKE CARB SS, 3/4"
M10AFFC12	2-1/16" 10,000 LB FXF ADJ CHOKE CARB 1"
M10PFXF2	2-1/16" 10,000 LB FXF POSITIVE CHOKE

ADJUSTABLE AND POSITIVE CHOKE PARTS

PART NO.	DESCRIPTION
1. M23HNXX	5/8-11 HEX NUT
2. M23FWXX	FLAT WASHER
3. M23HWXX	HAND WHEEL
4. M10STRX	10M HS STEM
M10STCX	10M SS CARBIDE STEM
M10STCN	10M CARBIDE STEM, NACE
5. M10ID7X	3/4" ORIF. INDICATOR DRUM
M10ID1X	1" ORIF. INDICATOR DRUM
6. M23SSIX	5/16-18 SET SCREW FOR IND.
7. M10WNXX	WING NUT
8. M10SNRX	SNAP RING
9. M10BXXX	10M BONNET
M10BXXS	10M BONNET, SS
10. M23TBXX	TEFLON BALL
11. M10TSXX	THUMB SCREW
12. M10ORXX	O RING
M10ORAX	O RING, AFLAS
13. M10PSXX	PACKING SET
M10PSAX	PACKING SET, AFLAS
14. M10RRXX	RETAINER RING
M10RRXS	RETAINER RING, SS
15. M10SRXX	SPIRALOX RING
M10SRXS	SPIRALOX RING, SS
16. M10FXFB2	10M FL X FL BODY,
M10FXFB2S	10M FL X FL BODY, SS
17. M07SERX	3/4" HS SEAT
M07SECX	3/4" CARB. SEAT
M07SECN	3/4" CARB. SEAT, NACE
M01SERX	1" HS SEAT
M01SECX	1" CARB. SEAT
18. M10BPXX	BLANKING PLUG
M10BPTX	BLANKING PLUG, 1/2" TAP
M10BPXS	BLANKING PLUG, SS
19. M23PB04	PO. CERAMIC-LINED CHOKE BEAN
	THRU M23PB40
	M23PB41 THRU M23PB48

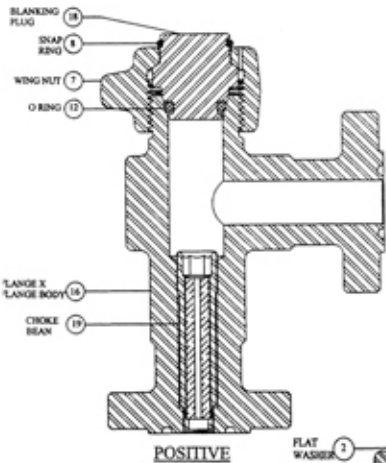

POSITIVE

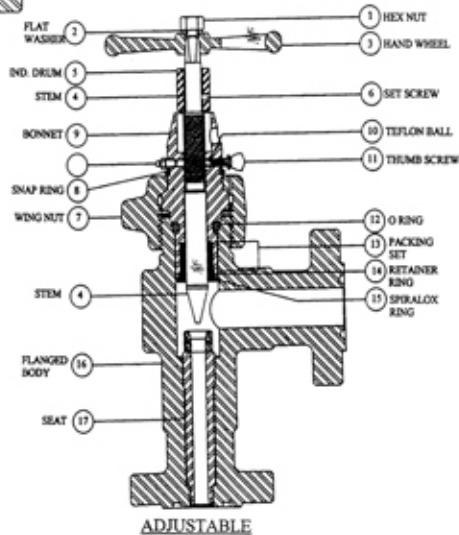

ADJUSTABLE

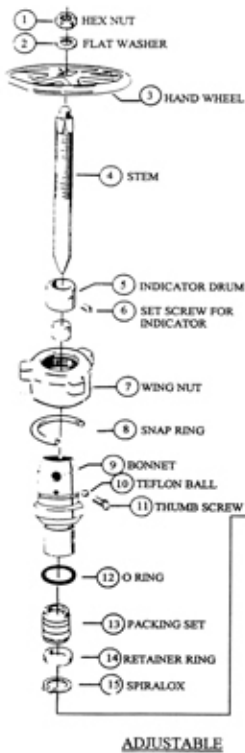

ADJUSTABLE

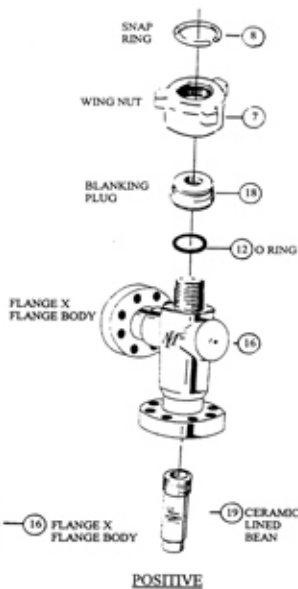

POSITIVE

ADJUSTABLE AND POSITIVE ASSEMBLIES

1-13/16" 10,000 LB W.P.

PART NO.	DESCRIPTION
M10AFFR7	1-13/16 10M FL X FL ADJ CHOKE HS 3/4"
M10AFFC7	1-13/16 10M FL X FL ADJ CHOKE CARB 3/4"
M10AFFC7S	1-13/16 10M FL X FL ADJ CHK. CARB 3/4" SS
M10AFFR1	1-13/16 10M FL X FL ADJ CHOKE HS 1"
M10AFFC1	1-13/16 10M FL X FL ADJ CHOKE CARB. 1"
M10PFXF	1-13/16 10M FL X FL POSITIVE CHOKE
M10PFXFS	1-13/16 10M FL X FL POSITIVE CHOKE,SS
M10BAR7	1-13/16 10M BONNET ASSY HS 3/4"
M10BAC7	1-13/16 10M BONNET ASSY CARB 3/4"
M10BAC7-R	1-13/16 10M BONNET ASSY CARB 3/4", AFLAS
M10BAC7S	1-13/16 10M BONNET ASSY CARB 3/4", SS
M10BAR1	1-13/16 10M BONNET ASSY HS 1"
M10BAC1	1-13/16 10M BONNET ASSY CARB 1"
M10BAC1S	1-13/16 10M BONNET ASSY CARB 1", SS
M10WNAX	1-13/16 10M WING NUT ASSEMBLY
M10WNTAT	1-13/16 10M WING NUT ASSEMBLY, 1/2 TAP

ADJUSTABLE AND POSITIVE CHOKE PARTS

PART NO.	DESCRIPTION
1. M23HNXX	5/8-11 HEX NUT
2. M23FWXX	FLAT WASHER
3. M23HWXX	HAND WHEEL
4. M10STRX	10M HS STEM
M10STCX	10M CARBIDE STEM
M10STCN	10M CARBIDE STEM, NACE
5. M10ID7X	3/4" ORIF. INDICATOR DRUM
M10ID1X	1"ORIF. INDICATOR DRUM
6. M23SSIX	5/16-18 SET SCREW FOR INDICATOR
7. M10WNXX	WING NUT
8. M10SNRX	SNAP RING
9. M10BXXX	10M BONNET
M10BXXS	10M BONNET, SS
10. M23TBXX	TEFLON BALL
11. M10TSXX	THUMB SCREW
12. M10ORXX	O RING
M10ORAX	O RING AFLAS
13. M10PSXX	PACKING SET
M10PSAX	PACKING SET, AFLAS
14. M10RRXX	RETAINER RING
M10RRXS	RETAINER RING, SS
15. M10SRXX	SPIRALOX RING
M10SRXS	SPIRALOX RING, SS
16. M10FXFB	10M FL X FL BODY
M10FXFBS	10M FL X FL BODY, SS
17. M07SERX	3/4" HS SEAT
M07SECX	3/4" CARB. SEAT
M07SECN	3/4" CARB. SEAT, NACE
M01SERX	1" HS SEAT
M01SECX	1" CARB. SEAT
18. M10BPXX	BLANKING PLUG
M10BPTX	BLANKING PLUG, 1/2" TAP
M10BPXS	BLANKING PLUG, SS
19. M23PB04	PO. CERAMIC-LINED CHOKE BEAN
	THRU M23PB40
	M23PB41 THRU M34PB48

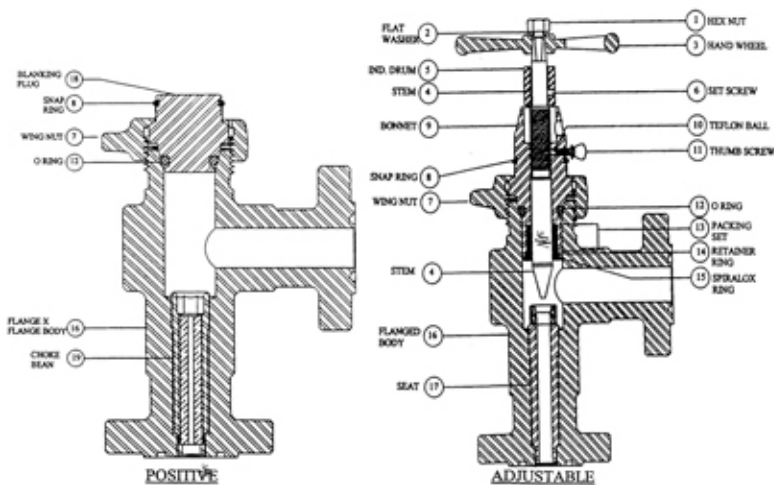

ADJUSTABLE AND POSITIVE CHOKE ASSEMBLIES

PART NO.	DESCRIPTION
M25AFFR7A	2-1/16" 5M FL X FL ADJ CHOKE HS 3/4"
M25AFFC7A	2-1/16" 5M FL X FL ADJ CHOKE CARB. 3/4"
M25AFFC7AS	2-1/16" 5M FL X FL ADJ CHOKE CARB 3/4"SS
M25AFFR1A	2-1/16" 5M FL X FL ADJ CHOKE HS 1"
M25AFFC1A	2-1/16" 5M FL X FL ADJ CHOKE CARB 1"
M25PFXFA	2-1/16" 5M POSITIVE FL X FL CHOKE
M25PFXFAS	2-1/16" 5M POSITIVE FL X FL CHOKE, SS
M25BAR7A	2-1/16" 5M BONNET ASSY HS 3/4"
M25BAC7A	2-1/16" 5M BONNET ASSY CARB. 3/4"
M25BAC7AS	2-1/16" 5M BONNET ASSY CARB. 3/4",SS
M25BAR1A	2-1/16" 5M BONNET ASSY HS. 1"
M25BAC1A	2-1/16" 5M BONNET ASSY CARB. 1"
M25WNA	2-1/16" 5M WING NUT ASSEMBLY
M25WNA	2-1/16" 5M WING NUT ASSEMBLY, 1/2 TAP
M25WNA	2-1/16" 5M WING NUT ASSEMBLY, SS

ADJUSTABLE AND POSITIVE FLANGE X FLANGE CHOKE PARTS

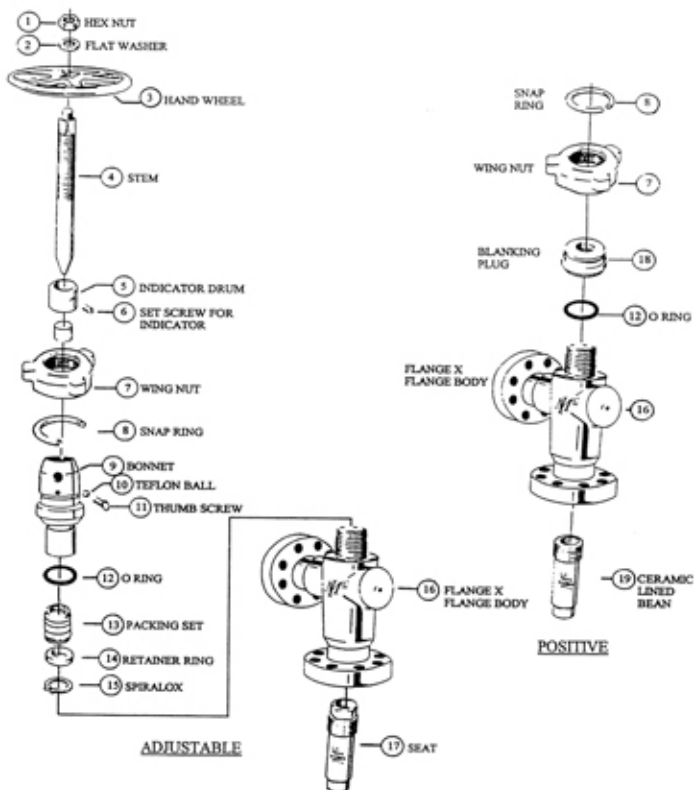

PART NO.	DESCRIPTION
1. M23HNXX	5/8"-11 HEX NUT
2. M23FWXX	FLAT WASHER
3. M23HWXX	HAND WHEEL
4. M10STRX	10M HS STEM
M10STCX	10M CARBIDE STEM
M10STCN	10M CARBIDE STEM, NACE
5. M10ID7X	3/4" ORIF. INDICATOR DRUM
M10ID1X	1"ORIF. INDICATOR DRUM
6. M23SSIX	5/16-18 SET SCREW FOR INDICATOR
7. M25WNXX	WING NUT
8. M25SNRX	SNAP RING
9. M25BXXX	5M JWA BONNET
M25BXXS	5M JWA BONNET,SS
10. M23TBXX	TEFLON BALL
11. M10TSXX	THUMB SCREW
12. M25ORXX	O RING
M25ORAX	O RING, AFLAS
13. M10PSXX	PACKING SET
M10PSAX	PACKING SET, AFLAS
14. M10RRXX	RETAINER RING
M10RRXS	RETAINER RING, SS
15. M10SRXX	SPIRALOX RING
M10SRXS	SPIRALOX RING, SS
16. M25FXFBA	FLANGE X FLANGE BODY, JWA
M25FXFBAS	FLANGE X FLANGE BODY, JWA, SS
17. M07SERX	3/4" HS SEAT
M07SECX	3/4" CARB. SEAT
M07SECN	3/4" CARB. SEAT, NACE FOR SS
M01SERX	1" HS SEAT
M01SECX	1" CARB. SEAT
18. M25BPXX	BLANKING PLUG
M25BPTX	BLANKING PLUG, 1/2" TAP
M25BPXS	BLANKING PLUG, SS
19. M23PB04	PO. CERAMIC-LINED CHOKE BEAN
	THRU M23PB40
	M23PB41 THRU M23PB48

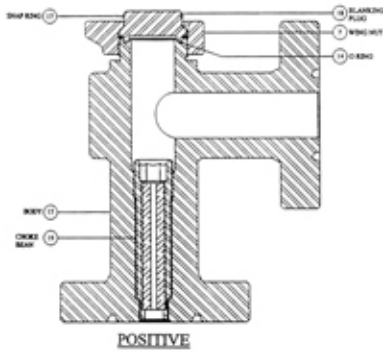

POSITIVE

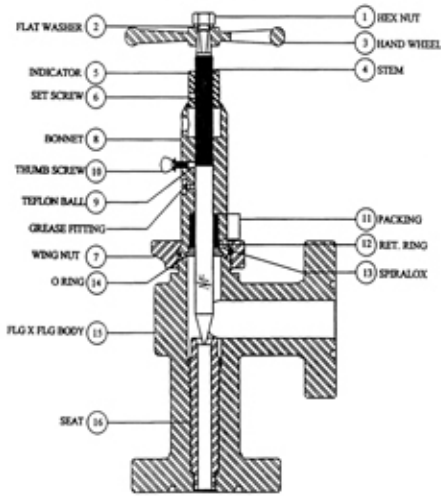

ADJUSTABLE

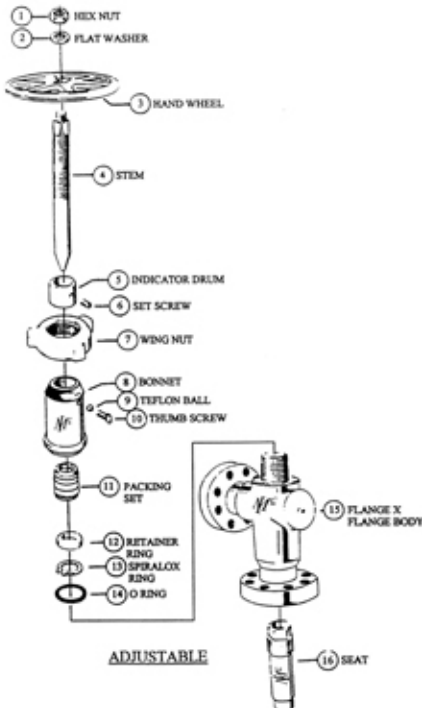

ADJUSTABLE

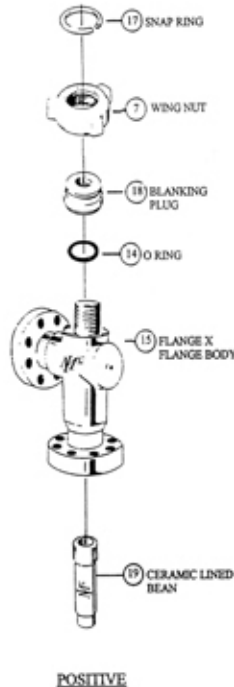

POSITIVE

ADJUSTABLE AND POSITIVE FL X FL CHOKE ASSEMBLIES
2" 5000 LB. W.P.

PART NO.	DESCRIPTION
M25AFFR7	2" 5M FL X FL ADJ CHOKE HS 3/4"
M25AFFC7	2" 5M FL X FL ADJ CHOKE CARB. 3/4"
M25AFFC7S	2" 5M FL X FL ADJ CHOKE CARB. 3/4", SS
M25AFFR1	2" 5M FL X FL ADJ CHOKE HS. 1"
M25AFFC1	2" 5M FL X FL ADJ CHOKE CARB. 1"
M25PFXF	2" 5M FL X FL POSITIVE CHOKE
M25PFXFS	2" 5M FL X FL POSITIVE CHOKE, SS
M25BAR7	2" 5M M-62 BONNET ASSY HS 3/4"
M25BAC7	2" 5M M-62 BONNET ASSY CARB. 3/4"
M25BAC7S	2" 5M M-62 BONNET ASSY CARB. 3/4", SS
M25BAR1	2" 5M M-62 BONNET ASSY HS 1"
M25BAC1	2" 5M M-62 BONNET ASSY CARB. 1"
M23WNAX	2 5M WING NUT ASSEMBLY
M23WNAT	2 5M WING NUT ASSEMBLY, 1/2" TAP
M23WNAXS	2 5M WING NUT ASSEMBLY, SS

ADJUSTABLE AND POSITIVE FL X FL CHOKE PARTS
2" 5000 LB W.P.

PART NO.	DESCRIPTION
1. M23HNXX	5/8-11 HEX NUT
2. M23FWXX	5/8 FLAT WASHER
3. M23HWXX	HAND WHEEL
4. M07STR2	N-62 3/4" HS STEM
M07STC2	N-62 3/4" CARB. STEM
M07STC2N	N-62 3/4" CARB. STEM, NACE
M01STR2	N-62 1" HS STEM
M01STC2	N-62 1" CARB. STEM
5. M23ID7X	3/4" ORIF. INDICATOR DRUM
M23ID1X	1" ORIF. INDICATOR DRUM
6. M23SSIX	5/16-18 SET SCREW FOR INDICATOR
7. M23WNXX	WING NUT
8. M23BXXX	BONNET
M23BXXS	BONNET, SS
9. M23TBXX	TEFLON BALL
10. M23TSXX	THUMBSCREW
11. M23PSXX	PACKING SET
12. M23RRXX	RETAINER RING
13. M23SRXX	SPIRALOX
14. M23ORXX	O RING
M23ORAX	O RING, AFLAS
15. M25FXFB	FLANGE X FLANGE BODY
16. M07SERX	3/4" HS SEAT
M07SECX	3/4" CARB SEAT
M01SERX	1" HS SEAT
M01SECX	1" CARB. SEAT
17. M23SNRX	SNAP RING
18. M23BPXX	BLANKING PLUG
M23BPTX	BLANKING PLUG, 1/2" TAP
19. M23BP04	POS. CERAMIC-LINED CHOKE BEAN
	THRU M23PB40
	M23PB41 THRU M23PB48

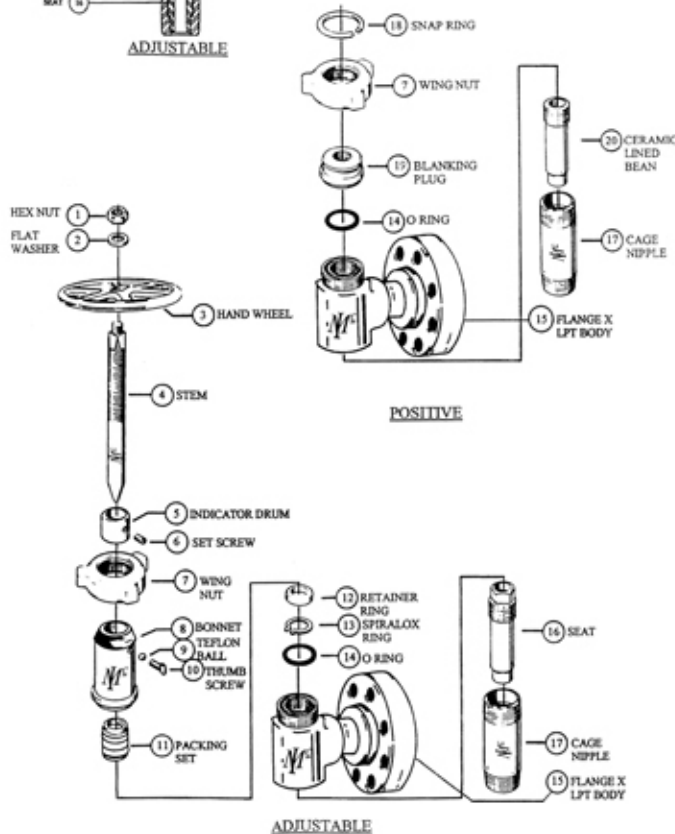
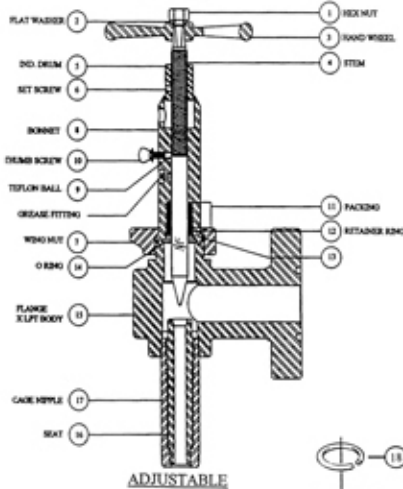
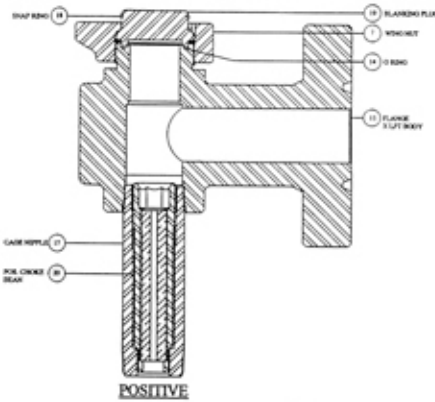

ADJUSTABLE AND POSITIVE FLANGE X LPT CHOKE ASSEMBLIES
2" 5000 LB W.P.

PART NO.	DESCRIPTION
M25AFSR7	2" 5M FLANGE X LPT ADJ CHOKE HS 3/4"
M25AFSC7	2" 5M FLANGE X LPT ADJ CHOKE CARB 3/4"
M25AFSR1	2" 5M FLANGE X LPT ADJ CHOKE HS 1"
M25AFSC1	2" 5M FLANGE X LPT ADJ CHOKE CARB 1"
M25PFXS	2" 5M POSITIVE CHOKE
M25PFXST	2" 5M POSITIVE CHOKE, 1/2" TAP
M25AFSC7-R	2" 5M FLANGE X LPT ADJ. CHOKE CARB. 3/4" TRIM WITH AFLAS

ADJUSTABLE AND POSITIVE FL X LPT CHOKE PARTS
2" 3/5000 LB W.P.

PART NO.	DESCRIPTION
1. M23HNXX	5/8-11 HEX NUT
2. M23FWXX	5/8 FLAT WASHER
3. M23HWXX	HAND WHEEL
4. M07STRX	N-60 3/4" HS STEM
M07STCX	N-60 3/4" CARB. STEM
M01STRX	N-60 1" HS STEM
M01STCX	N-60 1" CARB. STEM
5. M23ID7X	3/4" ORIF. INDICATOR DRUM
M23ID1X	1" ORIF. INDICATOR DRUM
6. M23SSIX	5/16-18 SET SCREW FOR INDICATOR
7. M23WNXX	WING NUT
8. M23BXXX	BONNET
9. M23TBXX	TEFLON BALL
10. M23TSXX	THUMBSCREW
11. M23PSXX	PACKING SET
12. M23RRXX	RETAINER RING
13. M23SRXX	SPIRALOX
14. M23ORXX	O RING
15. M25FXSB	FLANGE X LPT BODY
16. M07SERX	3/4" HS SEAT
M07SECX	3/4" CARB SEAT
M01SERX	1" HS SEAT
M01SECX	1" CARB. SEAT
17. M23CNXX	CAGE NIPPLE
18. M23SNRX	SNAP RING
19. M23BPXX	BLANKING PLUG
M23BPTX	BLANKING PLUG 1/2" TAP
20. M23PB04	POS. CERAMIC-LINED CK BEAN

THRU M23PB40
M23PB41 THRU M23PB48



2" 3000/5000 LB WP LPT X LPT

ADJUSTABLE AND POSITIVE CHOKE ASSEMBLIES

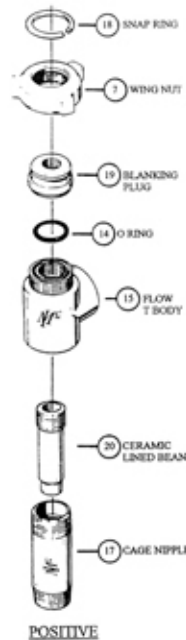
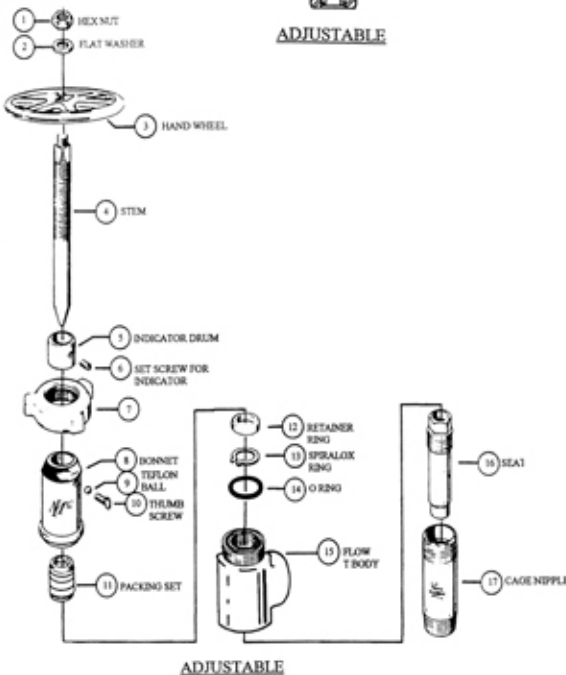
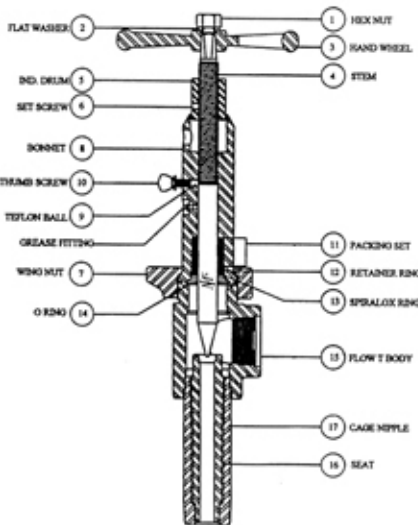
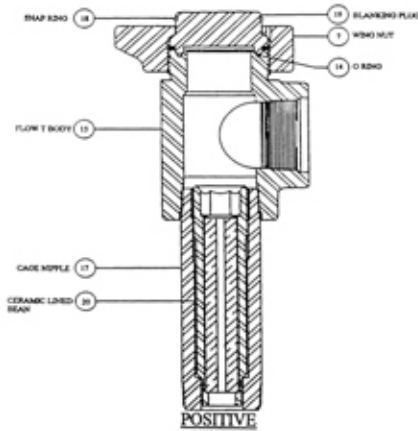

PART NO.	DESCRIPTION
M23ASSR7	2" 3M LPT X LPT ADJ CHK HS 3/4"
M23ASSC7	2" 3M LPT X LPT ADJ CHK CARB. 3/4"
M25ASSR7	2" 5M LPT X LPT ADJ CHK HS 3/4"
M25ASSC7	2" 5M LPT X LPT ADJ CHK CARB. 3/4"
M23ASSR1	2" 3M LPT X LPT ADJ CHK HS. 1"
M23ASSC1	2" 3M LPT X LPT ADJ CHK CARB. 1"
M25ASSR1	2" 5M LPT X LPT ADJ CHOKE HS 1"
M25ASSC1	2" 5M LPT X LPT ADJ CHOKE CARB. 1"
M23PSXS	2" 3M POSITIVE
M23PSXST	2" 3M POSITIVE 1/2" TAP
M25PSXS	2" 5M LPT X LPT POSITIVE CHOKE
M25PSXST	2" 5M LPT X LPT POSITIVE CHK., 1/2" TAP
M23FTAX	2" 3M FLOW TEE ASSY.
M23FTAT	2" 3M FLOW TEE ASSY. 1/2" TAP
M25FTAX	2" 5M FLOW TEE ASSEMBLY
M25FTAT	2" 5M FLOW TEE ASSEMBLY, 1/2" TAP
M23WNAX	2" 3/5M WING NUT ASSEMBLY
M23WNAT	2" 3/5M WING NUT ASSY. 1/2" TAP
M23BAR7	2" 3/5M BONNET ASSEMBLY HS 3/4"
M23BAR1	2" 3/5M BONNET ASSEMBLY HS 1"
M23BAC7	2" 3/5M BONNET ASSEMBLY CARB. 3/4"
M23BAC1	2" 3/5M BONNET ASSEMBLY CARB. 1"

ADJUSTABLE AND POSITIVE CHOKE PARTS

PART NO.	DESCRIPTION
1. M23HNXX	5/8-11 HEX NUT
2. M23FWXX	5/8 FLAT WASHER
3. M23HWXX	HAND WHEEL
4. M07STRX	N-60 3/4" HS STEM
M07STCX	N-60 3/4" CARB. STEM
M01STRX	N-60 1" HS STEM
M01STCX	N-60 1" CARB. STEM
5. M23ID7X	3/4" ORIF. INDICATOR DRUM
M23ID1X	1" ORIF. INDICATOR DRUM
6. M23SSIX	5/16-18 SET SCREW FOR INDICATOR
7. M23WNXX	WING NUT
8. M23BXXX	BONNET
9. M23TBXX	TEFLON BALL
10. M23TSXX	THUMBSCREW
11. M23PSXX	PACKING SET
M23PSAX	PACKING SET, AFLAS
12. M23RRXX	RETAINER RING
13. M23SRXX	SPIRALOX
14. M23ORXX	O RING
M23ORAX	O RING
15. M25FTBX	5M FLOW TEE BODY
16. M07SERX	3/4" HS SEAT
M07SECX	3/4" CARB SEAT
M01SERX	1" HS SEAT
M01SECX	1" CARB. SEAT
17. M23CNXX	CAGE NIPPLE
18. M23SNRX	SNAP RING
19. M23BPXX	BLANKING PLUG
M23BPTX	BLANKING PLUG 1/2" TAP
20. M23PB04	POS. CERAMIC-LINED CK BEAN

THRU M23PB40

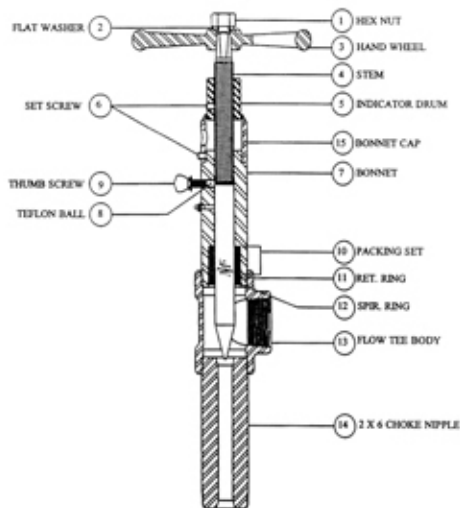

ADJUSTABLE CHOKE PARTS

2" 2000 LB. W.P.

PART NO.

DESCRIPTION

M22ASSR7	2" 2M LPT X LPT ADJ CHOKE HS 3/4"
M22ASSC7	2" 2M LPT X LPT ADJ CHOKE CARB 3/4"
M22ASSR1	2" 2M LPT X LPT ADJ CHOKE HS 1"
M22ASSC1	2" 2M LPT X LPT ADJ CHOKE CARB 1"
M22BAR7	2" 2M BONNET ASS'Y HS 3/4"
M22BAC7	2" 2M BONNET ASS'Y CARB 3/4"
M22BAR1	2" 2M BONNET ASS'Y HS 1"
M22BAC1	2" 2M BONNET ASS'Y CARB 1"

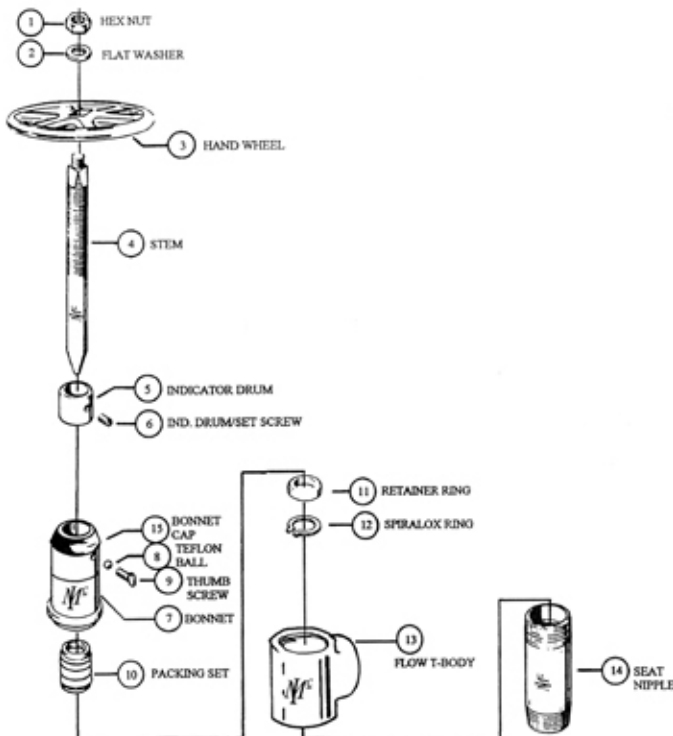

PARTS LIST AND PRICES

2" 2000 LB. W.P.

PART NO.

DESCRIPTION

1.	M23HNXX	5/8-11 HEX NUT
2.	M23FWXX	5/8 FLAT WASHER
3.	M23HWXX	HAND WHEEL
4.	M07STRX	M-60 3/4" HS STEM
	M07STCX	M-60 3/4" CARB. STEM
	M01STRX	M-60 1" HS STEM
	M01STCX	M-60 1" CARB. STEM
5.	M23ID7X	3/4" ORIFICE INDICATOR
	M23IDIX	1" ORIFICE INDICATOR
6.	M23SSIX	5/16-18 INDICATOR SET SCREW
7.	M22BXXX	BONNET
8.	M23TBXX	TEFLON BALL
9.	M23TSXX	THUMB SCREW
10.	M23PSXX	PACKING SET
11.	M23RRXX	RETAINER RING
12.	M23SRXX	SPIRALOX RING
13.	M22FTBX	2M FLOW TEE BODY
14.	M22CNR7	2 X 6 CHOKE NIPPLE, HS 3/4"
	M22CNC7	2 X 6 CHOKE NIPPLE, CARB 3/4"
	M22CNR1	2 X 6 CHOKE NIPPLE, HS 1"
	M22CNC1	2 X 6 CHOKE NIPPLE, CARB., 1"
15.	M22ICBX	BONNET CAP, IND. CAGE

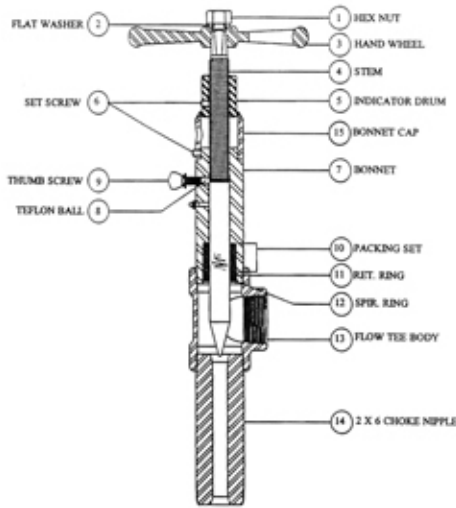

ADJUSTABLE CHOKE ASSEMBLY

2" 2000 LB. W.P.

PART NO.	DESCRIPTION
M22ASSR7S	2" 2000 LB. LPT X LPT ADJ. CHOKE HS 3/4"
M22BAR7S	2" 2000 LB. BONNET ASS'Y. HS. 3/4"

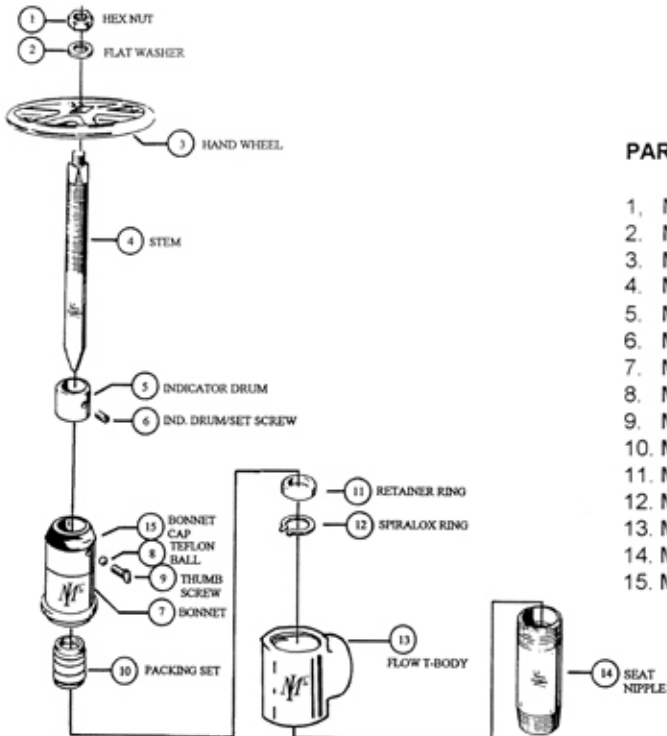

ADJUSTABLE CHOKE PARTS

2" 2000 LB. W.P.

PART NO.	DESCRIPTION
1. M23HNXX	5/8-11 HEX NUT
2. M23FWXX	5/8 FLAT WASHER
3. M23HWXX	HAND WHEEL
4. M07STRS	M-29 STEM, HS
5. M23ID7X	3/4" ORIFICE INDICATOR
6. M23SSIX	5/16-18 INDICATOR SET SCREW
7. M22BXXS	M-29 BONNET
8. M23TBXX	TEFLON BALL
9. M23TSXX	THUMB SCREW
10. M22PSXX	PACKING SET
11. M23RRXX	RETAINER RING
12. M23SRXX	SPIRALOX RING
13. M22FTBS	M-29 FLOW TEE BODY
14. M22CNR7S	M-29 SEAT/NIPPLE, HS
15. M22ICBX	BONNET CAP, INDICATOR CAGE



MISCELLANEOUS PARTS

PART NO.	DESCRIPTION
M23CWXX	CHOKE WRENCH
M23PCWX	"P" CHOKE WRENCH
M23GFXX	GREASE FITTING
M23CFXX	2" COMPANION FLANGE
M23PB- -SC	FULL LINED CARB. FLOW BEANS:
4/64 - 31/64	OCT STYLE SS FLOW BEAN JACKET
32/64 - 48/64	WITH FULL CARBIDE LINER
	DITTO

CHOKE NIPPLES:

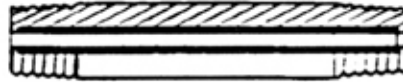

	CHOKE NIPPLE SIZES IN 64THS.
M14CNA--	1 X 4 ALLOY CHOKE NIPPLE
M16CNA--	1 X 6 ALLOY CHOKE NIPPLE
M26CNA--	2 X 6 ALLOY CHOKE NIPPLE
M14CNM--	1 X 4 CERAMIC LINED CHK. NIPPLE
M16CNM--	1 x 6 CERAMIC LINED CHK. NIPPLE
M26CNM--	2 X 6 CERAMIC LINED CHK. NIPPLE

M07SECFL	FULLY LINED CARBIDE SEATS 3/4" FULLY LINED CARB. SEAT
----------	---



FLOW CONTROL PARTS
FOR OTHER CHOKE MANUFACTURERS

CAMERON:

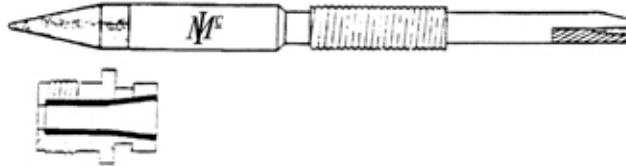

PART NO.	DESCRIPTION
CA07SER/10	CAM. TYPE H-2 HS 3/4" SEAT/10M
CA07SEC/10	CAM. TYPE H-2 CARB. 3/4" SEAT/10M
CA01SER/10	CAM. TYPE H-2 HS. 1" SEAT/10M
CA01SEC/10	CAM. TYPE H-2 CARB.. 1" SEAT/10M
CASTR/10	CAM. TYPE H-2 HS STEM, 10M
CASTC/10	CAM. TYPE H-2 CARB. STEM, 10M
CASTR/15	CAM. TYPE H-2 HS. STEM, 15M
CASTC/15	CAM. TYPE H-2 CARB. STEM, 15M

THORNHILL CRAVER STYLE:

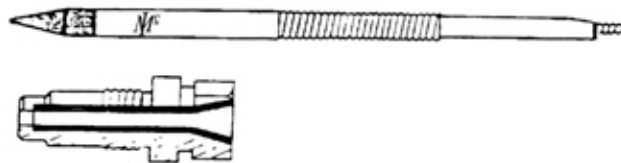

TC3SER7	TC TYPE 1003-A 3/4" HS SEAT
TC3SEC7	TC TYPE 1003-A 3/4" CARB. SEAT
TC3SER1	TC TYPE 1003-A 1" HS SEAT
TC3SEC1	TC TYPE 1003-A 1" CARB. SEAT
TC94STR	TC TYPE 894 HS STEM
TC94STC	TC TYPE 894 CARB. STEM
TC99STR	TC TYPE 899 HS STEM
TC99STC	TC TYPE 899 CARB. STEM
TC6SER7	TC TYPE 642 3/4" HS SEAT
TC6SEC7	TC TYPE 642 3/4" CARB. SEAT
TC6SER1	TC TYPE 642 1" HS. SEAT
TC6SEC1	TC TYPE 642 1" CARB. SEAT
TCPB04 -- 40	TC TYPE CER.- LINED POS. CHOKE BEAN, (TC1003P)
TCPB41 -- 48	DITTO

NOTE: NATIONAL STYLE POSITIVE CHOKE BEANS AVAILABLE UPON REQUEST



FLOW CONTROL PARTS
FOR OTHER CHOKE MANUFACTURERS

MCEVOY STYLE:

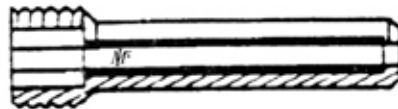

PART NO.	DESCRIPTION
MCEVOY:	
MEPB04 THRU 40	MCEVOY TYPE CERAMIC -LINED CHOKE BEAN
MEPB41 THRU 48	DITTO
MECNXX	MCEVOY TYPE CAGE NIPPLE
GRAY TOOL CO:	
GRPB04 THRU 40	GRAY 60 TYPE CERAMIC- LINED CHOKE BEAN
GRPB41 THRU 48	DITTO
GRCNXX	GRAY TYPE CAGE NIPPLE
GRCWXX	GRAY TYPE CHOKE WRENCH
GULFCO:	
GFGPB04 THRU 40	GULFCO TYPE AG(SHORT) STYLE CERAMIC LINED CHOKE BEAN
GFGPB41 THRU 48	DITTO
(*TYPE AB(LONG) STYLE AVAILABLE ON REQUEST)	
GFCNXX	GULFCO TYPE CAGE NIPPLE
GF07SER	GULFCO TYPE AB-75 HS SEAT
GF07SEC	GULFCO TYPE AB-75 CARB. SEAT
GF01SER	GULFCO TYPE AB-100 HS SEAT
GF01SEC	GULFCO TYPE AB-100 CARB. SEAT
GF07STR	GULFCO TYPE AB-75 HS STEM
GF07STC	GULFCO TYPE AB-75 CARB. STEM
GF01STR	GULFCO TYPE AB-100 HS STEM
GF01STC	GULFCO TYPE AB-100 CARB. STEM